

BOLLARD CONSTRUCTION NOTE:-

1. OUTDOOR RECREATION SYMBOL NO. 50 TO NZS 8603:1992 STANDARD, ON FRONT AND SIDES OF POSTS ONLY.
2. SYMBOLS AND DIRECTIONAL ARROWS TO BE CHECKED 10mm INTO POSTS.
3. 10mm ROUTED GROOVES TO BE CUT ON ALL FOUR FACES OF THE POSTS WITH THE GROOVES LINING UP.
4. GROOVES HIGHLIGHTED IN BLUE - AS DETAILED IN 282 CD1.
5. POST WITH SYMBOLS TO BE INSTALLED ON THE RIGHTHAND SIDE LOOKING INTO THE WALKWAY.
6. DIRECTIONAL ARROWS TO BE ON THE SIDE ONLY, AND POINTING INTO THE WALKWAY.



Franklin
DISTRICT COUNCIL

STANDARD DETAIL

PEDESTRIAN ACCESSWAY

DATE:

APRIL 2009

No:

P 1

NOTES:

1. FENCE SHOWN REPRESENTS THE MINIMUM STANDARD REQUIRED. ALTERNATIVE MAY BE AGREED BY THE ENGINEER.
2. PAVING BLOCKS OR SIMILAR MAY BE USED FOR THE ACCESSWAY SUBJECT TO THE PRIOR APPROVAL OF THE ENGINEER TO THE TYPE AND METHOD OF LAYING PROPOSED.

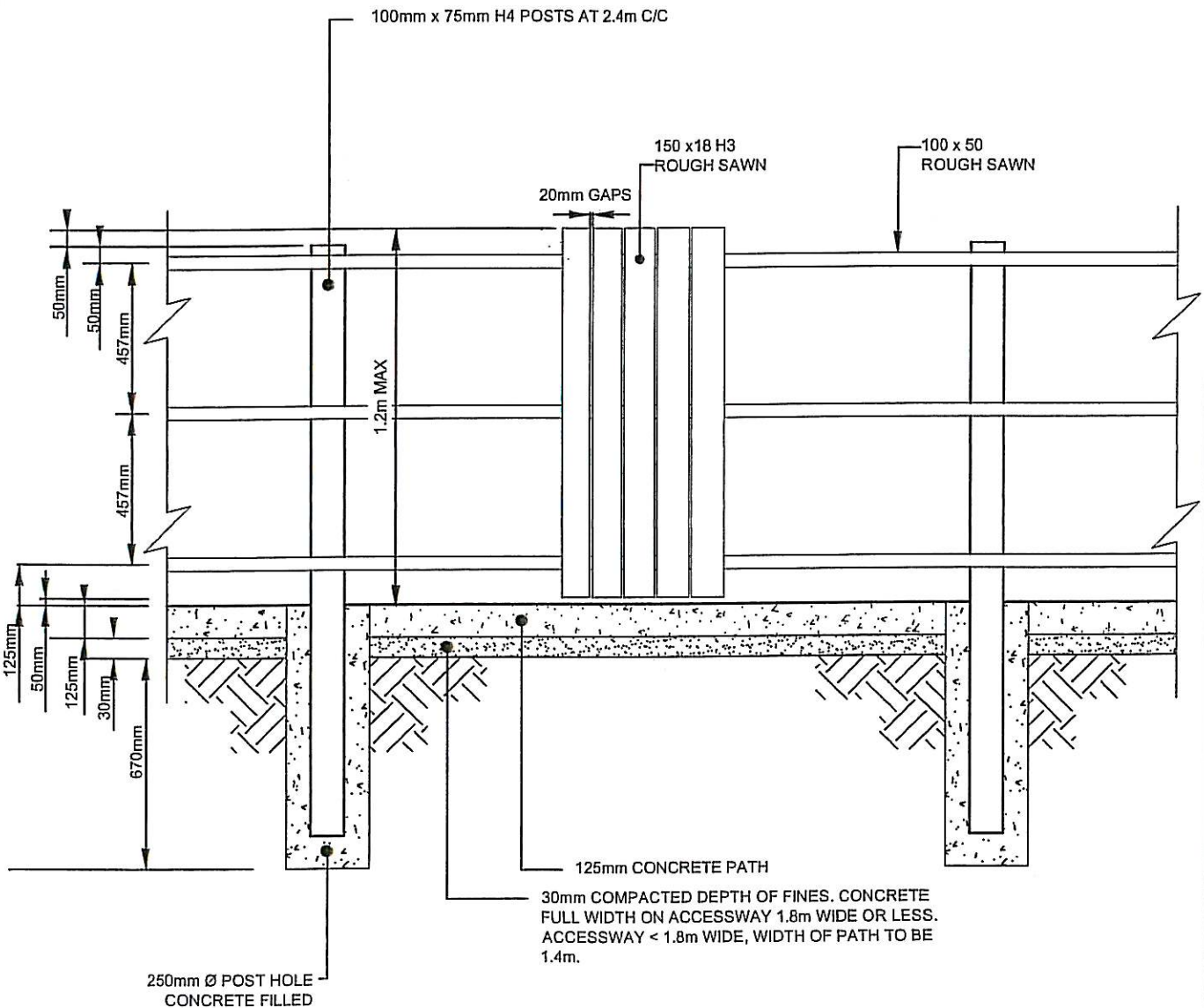

Franklin
DISTRICT COUNCIL

STANDARD DETAIL

PEDESTRIAN ACCESSWAYS

DATE: AUGUST 2010

No: P 2

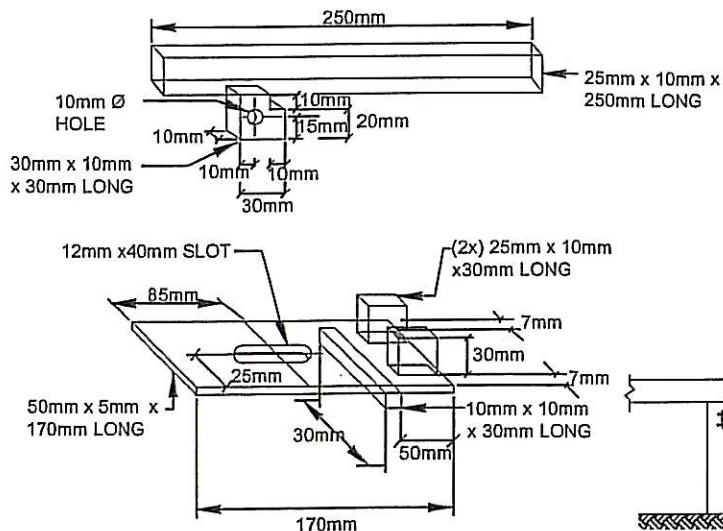

LATCH DETAIL

NOTE:

ALL COMPONENTS HOT DIPPED GALVANISED AND ALL FILLET WELDS ARE AT 5mm.

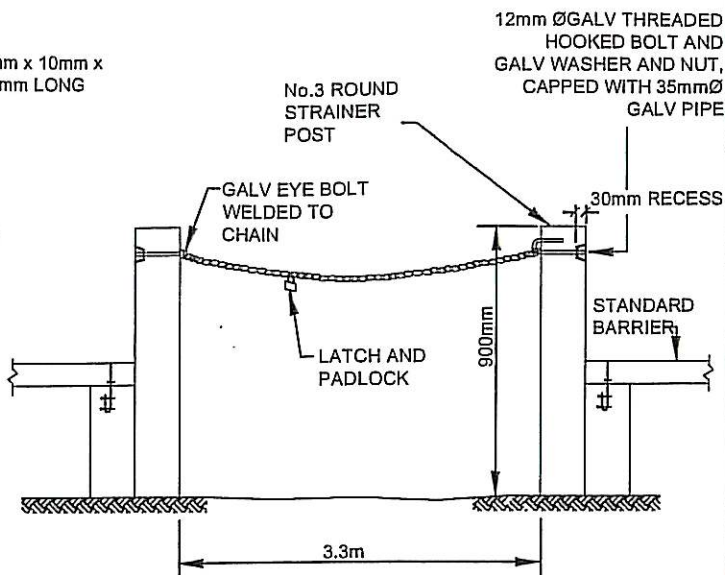

GATE DETAIL

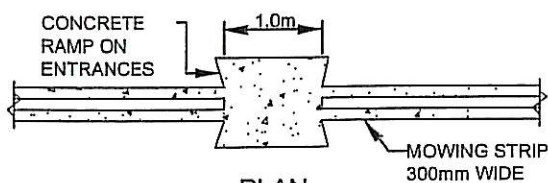

PLAN



PEDESTRIAN ACCESS ELEVATION

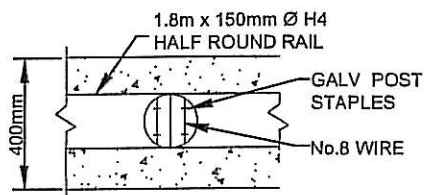

PLAN

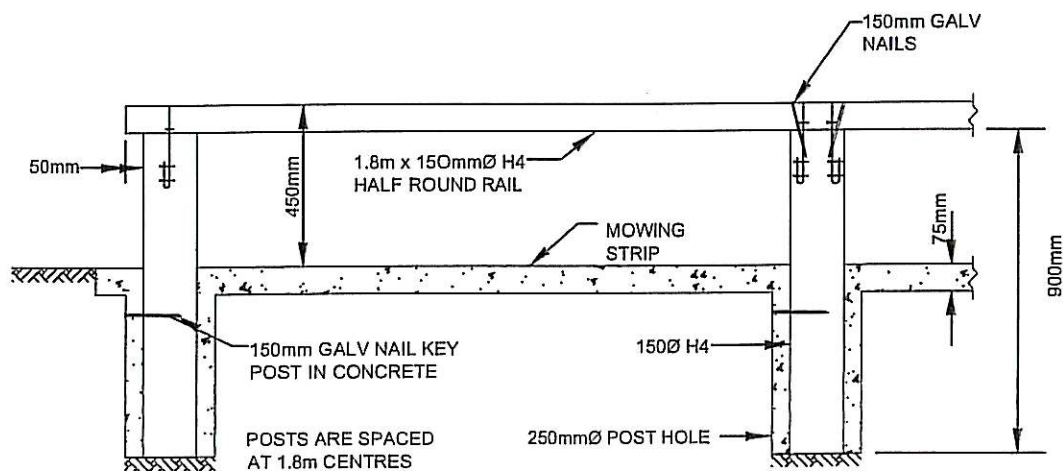

BARRIER END AND STANDARD POST DETAIL ELEVATION



Franklin
DISTRICT COUNCIL

DATE: APRIL 2009

No: P 3

STANDARD DETAIL

STANDARD PARK BARRIERS

NOTE:

SPECIFIC APPROVAL IS REQUIRED FOR STRUCTURES IN ROAD RESERVE CONSIDERING FOLLOWING CRITERIA

1. ROAD HIERARCHY
2. PROXIMITY OF THE ROAD INTERSECTION
3. PROXIMITY OF VEHICULAR AND PEDESTRIAN CROSSINGS
4. TRAFFIC VOLUME DUCTS WILL BE REQUIRED TO ALLOW FOR SERVICES

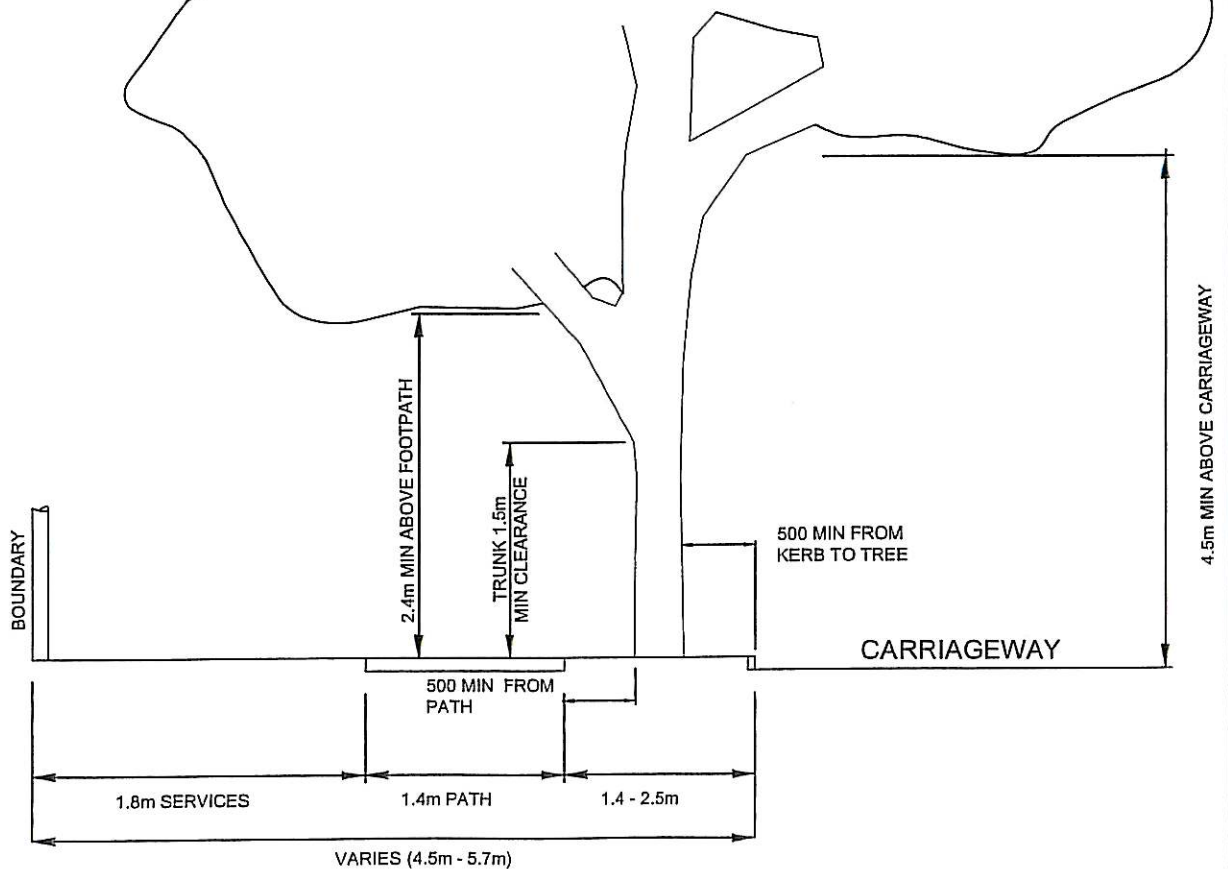

Franklin
DISTRICT COUNCIL

DATE:

APRIL 2009

No:

P 4

STANDARD DETAIL

STANDARD BERM CROSS -
SECTION WITH ENVELOPES
FOR TREE LANDSCAPING

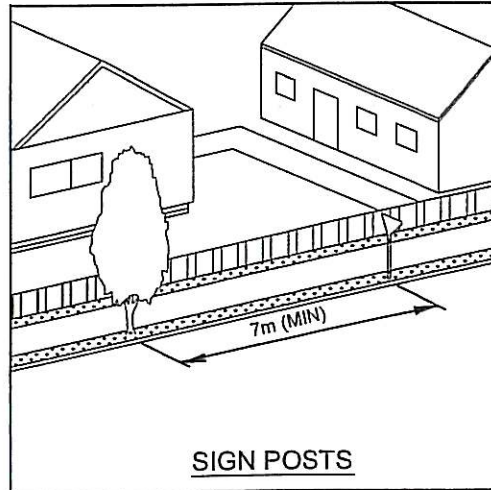
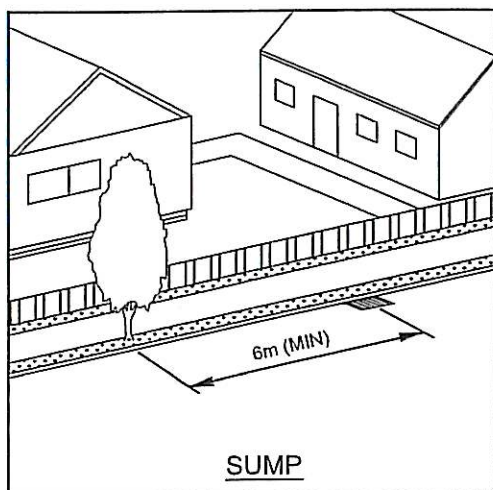
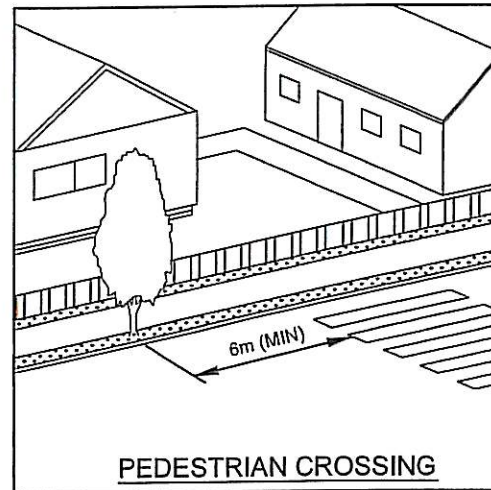
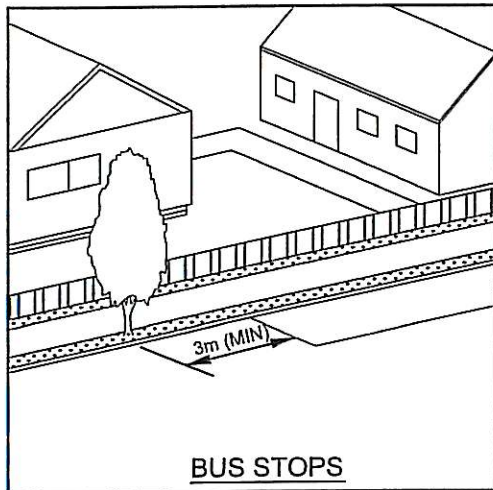
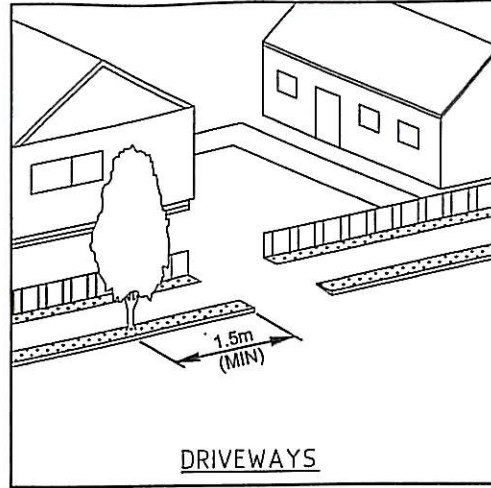
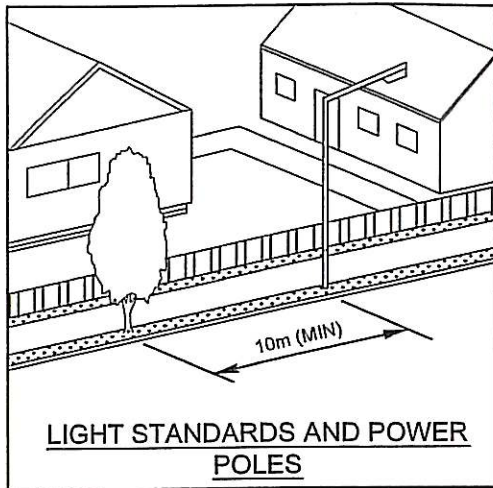

NOTE:

1. IN HIGH DENSITY URBAN RESIDENTIAL ZONES SOME FLEXIBILITY WITH REGARD TO THESE DIMENSIONS MAY BE PERMITTED.



Franklin
DISTRICT COUNCIL

DATE: AUGUST 2010

No: P 5

STANDARD DETAIL

PREFERRED STREET TREE PLACEMENT

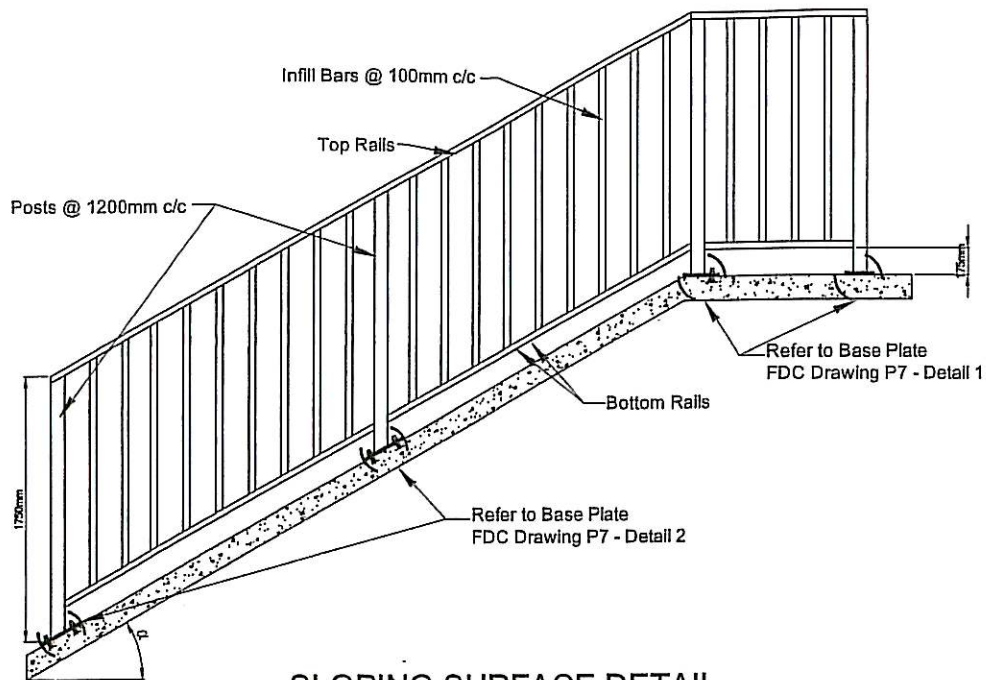

SLOPING SURFACE DETAIL
Elevation

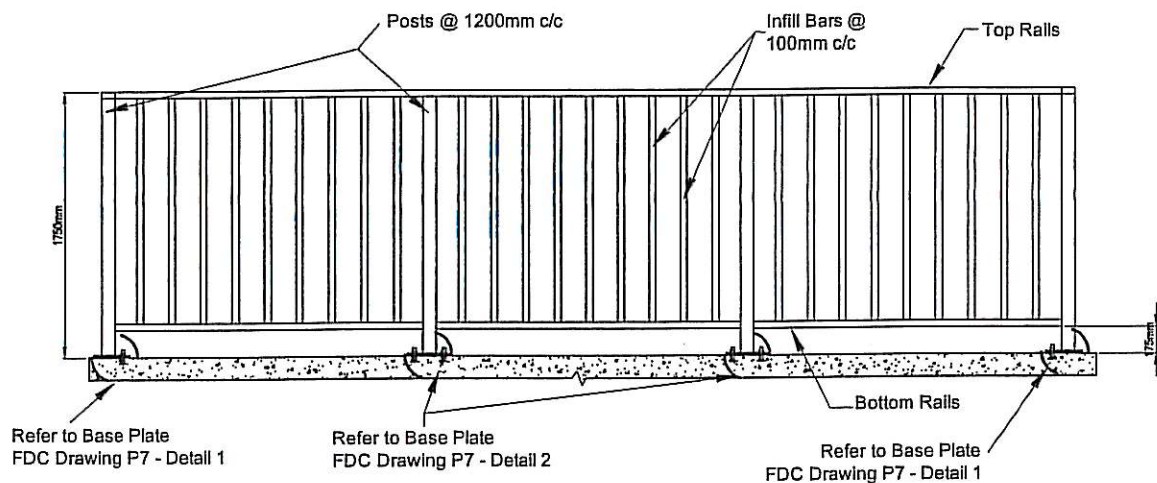

FLAT SURFACE DETAIL
Elevation

Notes:

1. Top & Bottom Rails : 50x25x3.0 RHS
2. Posts : 50x50x4.0 SHS
3. Infill Bars : 16x16 Square Solid Bar
4. Posts and Infill Bars to remain vertical on sloping surface
5. All exposed sharp edges and corners to be slightly rounded by grinding before galvanising
6. All steelwork to be hot dip galvanised. Coating to be 500g/m or equivalent.
7. All opening ends to be closed by welding a endplates before galvanising
8. Post fixings : M12 Bolts x 70mm length and washer
9. All bolt connections to be Grade 4.6 and snug-tightened
10. All RHS, SHS, Solid bars to be Grade C350
11. All Infill bars to be centered along top and bottom rails before welding
12. RHS connections are 3mm end-to-end butt-welds
13. Weld Connections:

Infill Bars:	3mm F.W.A.R
Base Plate to Post:	6mm F.W.A.R : $\alpha < 30^\circ$
	6mm F.W.A.R : $\alpha > 30^\circ$
Top & Bottom Rails to Post:	4mm F.W.A.R

(Note: F.W.A.R. = Fillet Weld All Round)



Franklin
DISTRICT COUNCIL

DATE:

SEPTEMBER 2010

No:

P 6

STANDARD DETAIL

PEDESTRIAN SAFETY HANDRAIL DETAILS

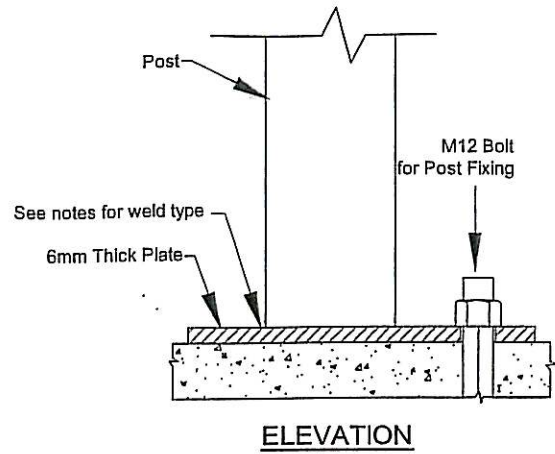
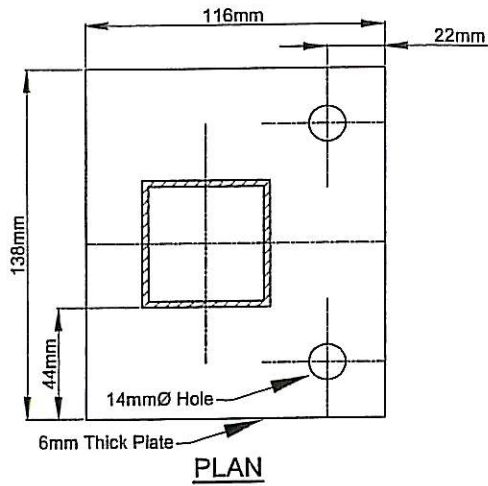

BASE PLATE DETAIL 1

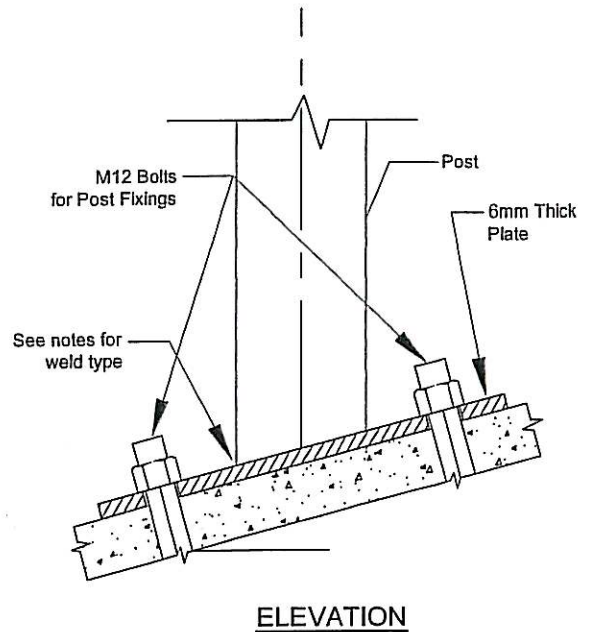
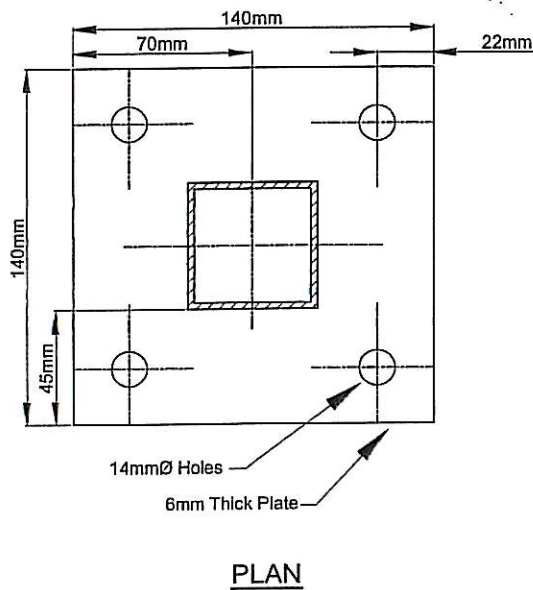

BASE PLATE DETAIL 2

NOTES:

- Weld Connections:
Base Plate to Post: 6mm F.W.A.R: $\alpha < 30^\circ$
6mm F.W.A.R: $\alpha > 30^\circ$
(Note: F.W.A.R. = Fillet Weld All Round)

- Base Plate Lengths:

	$\alpha < 30^\circ$	$\alpha > 30^\circ$
Detail 1 Base Plate Length	116mm	156mm
Detail 2 Base Plate Length	140mm	180mm



Franklin
DISTRICT COUNCIL

DATE: SEPTEMBER 2010

No: P 7

STANDARD DETAIL

**PEDESTRIAN SAFETY
HANDRAIL BASEPLATE
DETAILS**