

Appendix C – Historic Plans

Te Paeroa
W. Cunningham
Capt. Symonds says it

TE PAEROA

AROHA SURVEY DISTRICT

Scale 20 chains

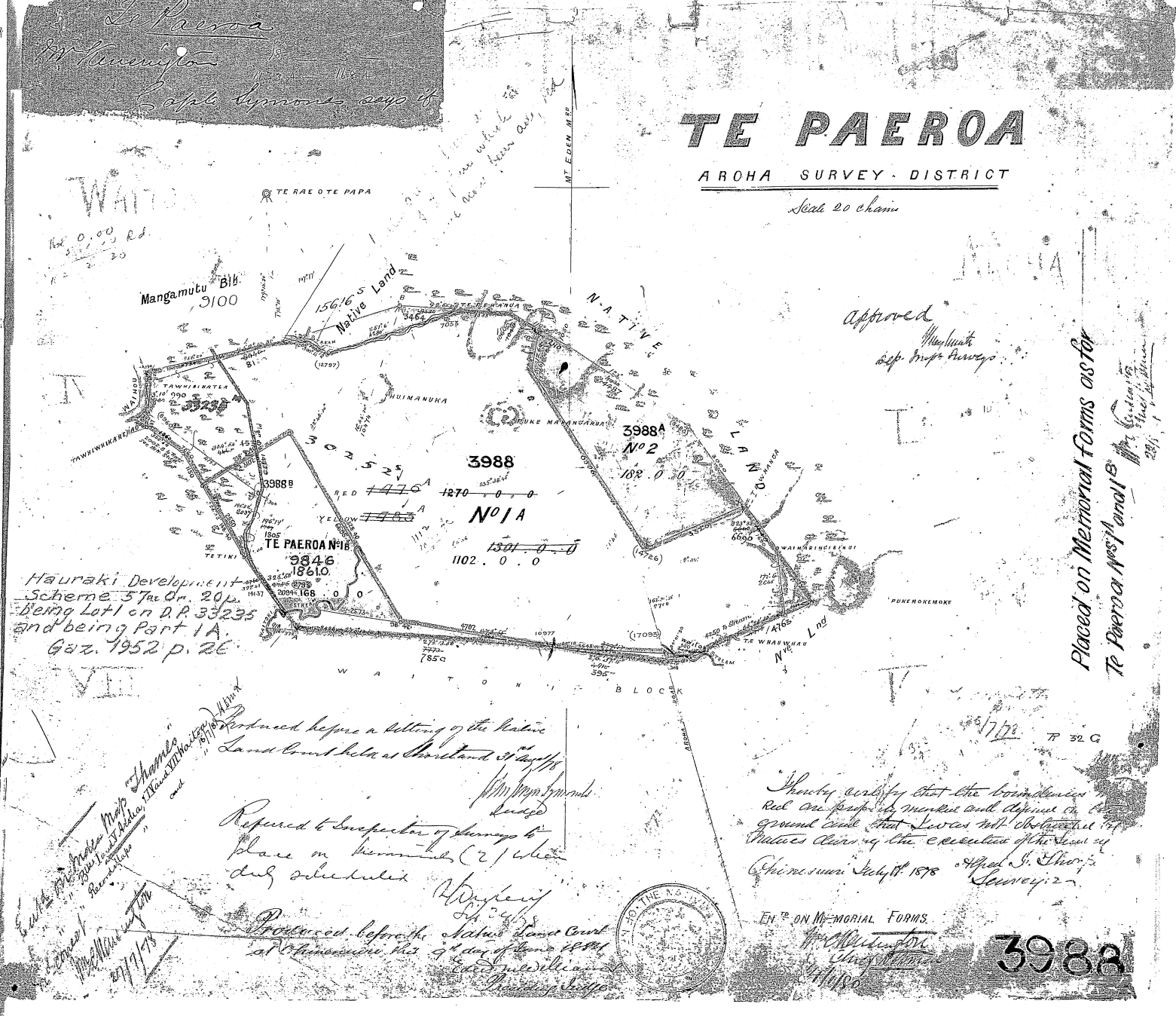

Approved
W. Cunningham
Exp. Imp. Survey

Placed on Memorial Forms as for
Te Paeroa Nos 1 and 2

Hauraki Development
Scheme 37a Op. 20
Being Lot 1 on D.P. 33235
and being Part 1A
Gaz. 1952 p. 26

Produced before a sitting of the Native
Land Court held at Hamilton at 11/1/18

Referred to Inspector of Survey to
place on Memorial (2) when
due submitted

Produced before the Native Land Court
at Hamilton, this 9th day of June 1881

I hereby certify that the boundaries
Red on paper in margin and shown on the
ground and that I was not obstructed by
Native during the execution of the Survey
at Te Paeroa 1878



EN² ON MEMORIAL FORMS

W. Cunningham
Exp. Imp. Survey
1880

3988

— PLAN OF —
— PUKEHANGE. —
— Block IV Waitoa, Survey District. —



Taumatawahine.

*Divided Parcel 21/1/18
 into Sublots 1, 2, 3, 4
 next full
 H.M.P. 11/11/98*

H. M. P. 11/11/98

*The Presiding Judge
 turned down applications
 for a declaration of title
 in respect of the
 above mentioned
 land.*

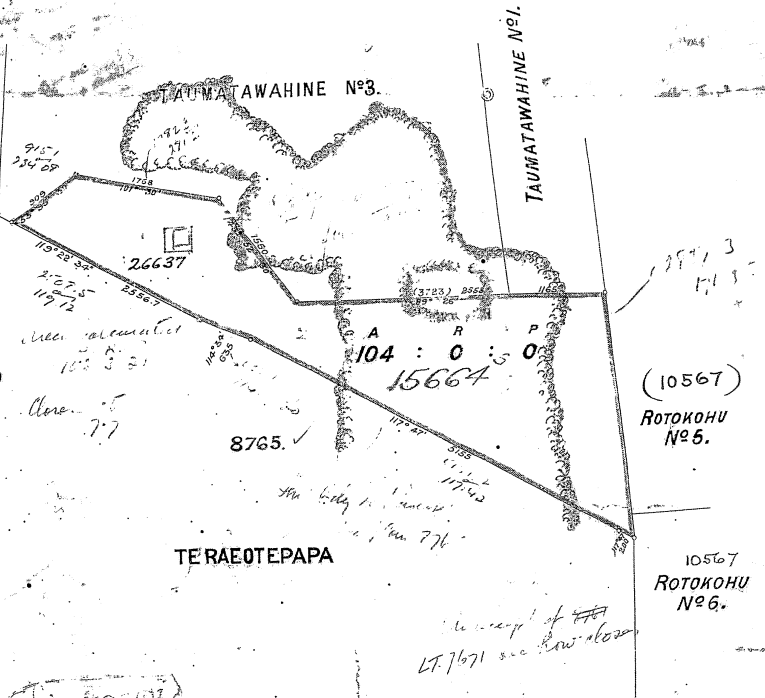

*Produced before N.Z. Court
 before Hon. J. G. Allen
 Judge
 14-4-95*

*Produced before the Native Appellate
 Court at Pora on 30th Oct 1899
 on appeal of Pukehange B.L. etc.*

*H. Scammell
 Presiding Judge*

TRACING SUPPLIED
 TO VALUATION DEPT.
 29 MAR 1916

*J.S.I.
 10/1/98*

Scale 10 Chains to 1 Inch.

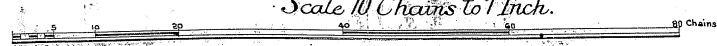

IV Waitoa, S.D.
 do do
 Ohinemuri Co.

6714.

NEW ZEALAND SURVEY DEPARTMENT.

20
 8/11
 Approved.
 Chief Surveyor.
 11/12/19

Ohihemuri County - Auckland Land Dist.

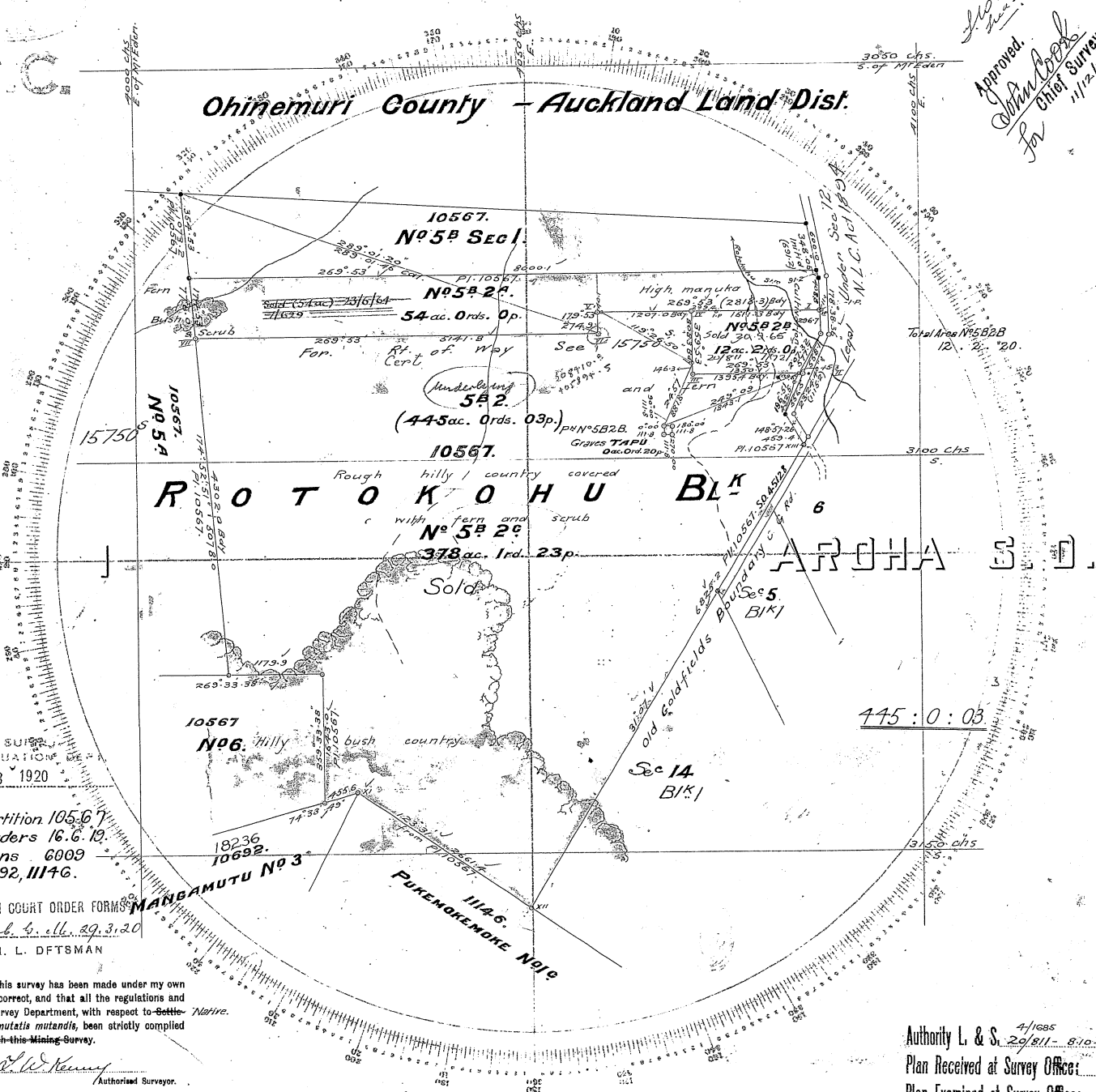

TRACING SURVEY
 TO VALUATION
 JUN 3 1920

Judge's Partition 10567
 Date of Orders 16.6.19
 Descriptions 6009
 10567, 10692, III+6.

ENDORSED ON COURT ORDER FORMS
 h. 4. 6. 29. 3. 20
 N. L. DFTSMAN

I hereby certify that this survey has been made under my own inspection, that it is correct, and that all the regulations and instructions of the Survey Department, with respect to Settlement Surveys, have, *mutatis mutandis*, been strictly complied with in connection with this Mining Survey.

Forwarded to the Chief Surveyor, on the 9th day of Decr, 1919.

PLAN OF ROTOKOHU NOS 5^B 2^A,
 5^B 2^B, & 5^B 2^C.

T.W. Kenny Surveyor.
 Nov 1919.

Scale: Ten Chains to an Inch.

Authority L. & S. 4/1885
 29/8/11 - 8/10/19
 Plan Received at Survey Office:
 Plan Examined at Survey Office:
 F. B. 3271. p. 23.

3271 P 23
 N. 6 p 88
 11 20 19
 20 13 20
 11 12 19

Costs checked F. B. 11/2/19

LAND DISTRICT OF AUCKLAND
N.L.C. DISTRICT WAIKATO-MANiapOTO

20/1360.



O.C.

OHINEMURI COUNTY.

D.P. 7671^M

T a u m a r a w a h i n e

BLK IV

BLK I

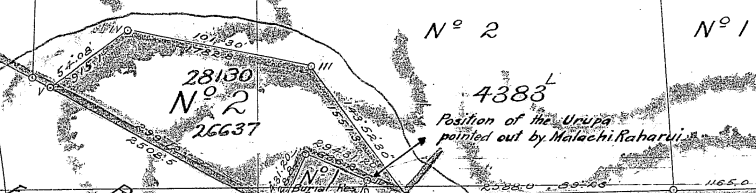

6714^S Cert
Pukehange Bk

D N° 4
15566^S
Total Area 103.1.11

W A I K A T O

A R O H A S I D

ENDORSED ON COURT ORDER FORMS
8071K. 23/4/36.
for N. L. DEISMAN

APPROVED
[Signature]
Judge.
6/5/1936

Orders made on Investigation
30/11/36 Hauraki Min. Bk. 43 p. 353
Investigation Plan 6714

FILE: 20/1360
AUTHORITY: 5/150 26:2:36
PARENT PLAN:
REF. PLANS:
Received: 23-3-36 No.
Fieldbook: 4456 Page 38
Transverse-book: N38. Folio: 50
Examined: *[Signature]* 2/4/36
Recorded:
Plan in order and ready for approval:

— PLAN OF —
Pukehange N^{os} 1 & 2
— Surveyed for the Chief Surveyor —
Surveyed by Courtenay Kenny Date: March 1936
Registered Surveyor.

SCALE: TEN CHAINS TO AN INCH.
I, Courtenay Kenny of Paeroa
Registered Surveyor, hereby certify that this plan has been made from surveys executed by me; that both plan and survey are correct, and have been made in accordance with the rules of the Survey Board.
Dated at Paeroa this 13th day of March, 1936
[Signature]
Registered Surveyor.

Approved as from 23. 3. 36
Survey agrees with Court order.
[Signature]
for Chief Surveyor.
3 14 36

Plan No.
15664

25 8/150.

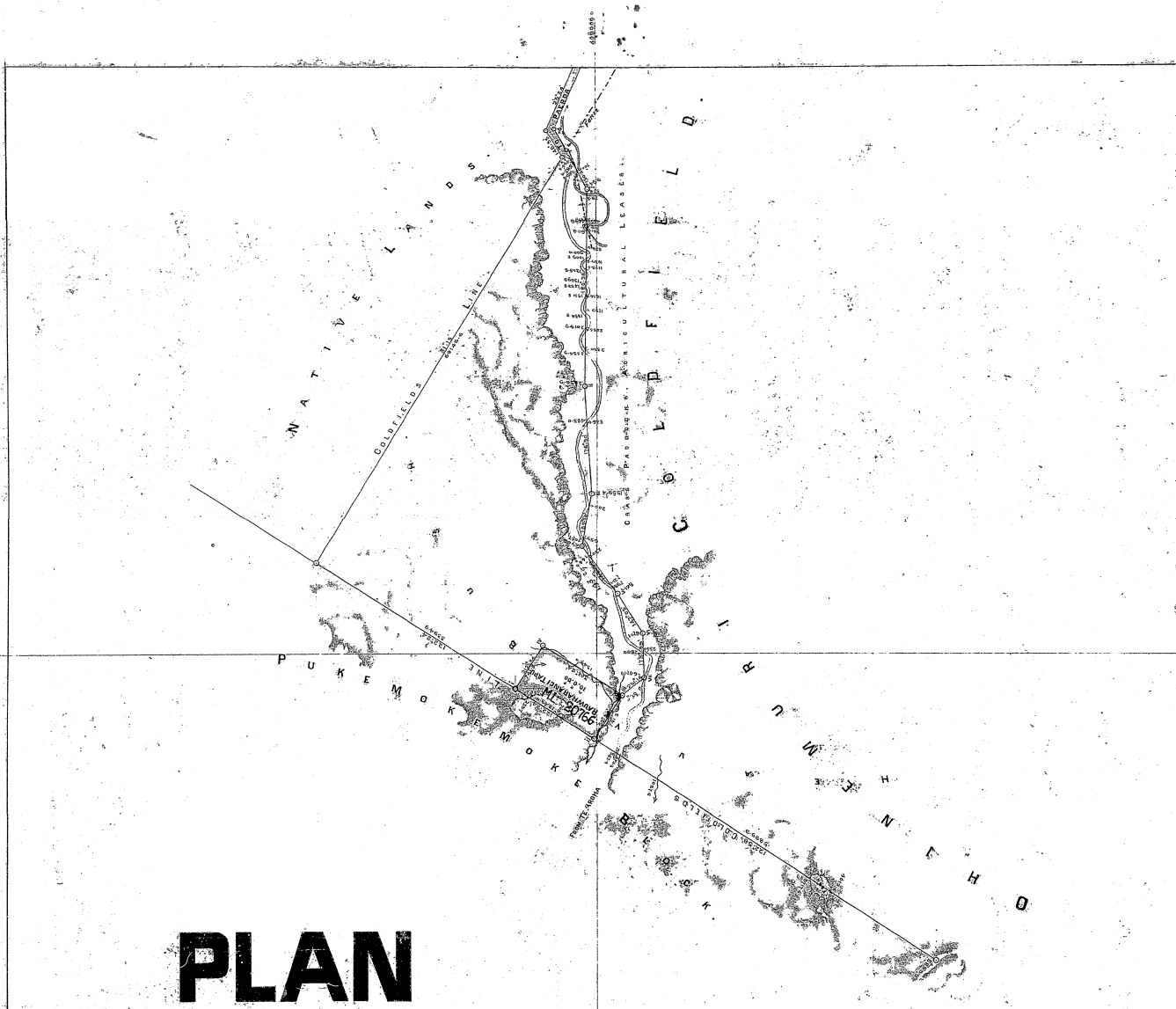

PLAN

RAUWHARANGI TAPU WAIHI

BLOCK I — AROHA SURVEY DISTRICT

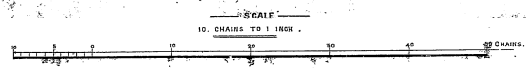

*Block I, Aroha, N.Z.
 Containing Blocks 1, 2, 3, 4, 5, 6, 7, 8, 9, 10, 11, 12, 13, 14, 15, 16, 17, 18, 19, 20, 21, 22, 23, 24, 25, 26, 27, 28, 29, 30, 31, 32, 33, 34, 35, 36, 37, 38, 39, 40, 41, 42, 43, 44, 45, 46, 47, 48, 49, 50, 51, 52, 53, 54, 55, 56, 57, 58, 59, 60, 61, 62, 63, 64, 65, 66, 67, 68, 69, 70, 71, 72, 73, 74, 75, 76, 77, 78, 79, 80, 81, 82, 83, 84, 85, 86, 87, 88, 89, 90, 91, 92, 93, 94, 95, 96, 97, 98, 99, 100, 101, 102, 103, 104, 105, 106, 107, 108, 109, 110, 111, 112, 113, 114, 115, 116, 117, 118, 119, 120, 121, 122, 123, 124, 125, 126, 127, 128, 129, 130, 131, 132, 133, 134, 135, 136, 137, 138, 139, 140, 141, 142, 143, 144, 145, 146, 147, 148, 149, 150, 151, 152, 153, 154, 155, 156, 157, 158, 159, 160, 161, 162, 163, 164, 165, 166, 167, 168, 169, 170, 171, 172, 173, 174, 175, 176, 177, 178, 179, 180, 181, 182, 183, 184, 185, 186, 187, 188, 189, 190, 191, 192, 193, 194, 195, 196, 197, 198, 199, 200, 201, 202, 203, 204, 205, 206, 207, 208, 209, 210, 211, 212, 213, 214, 215, 216, 217, 218, 219, 220, 221, 222, 223, 224, 225, 226, 227, 228, 229, 230, 231, 232, 233, 234, 235, 236, 237, 238, 239, 240, 241, 242, 243, 244, 245, 246, 247, 248, 249, 250, 251, 252, 253, 254, 255, 256, 257, 258, 259, 260, 261, 262, 263, 264, 265, 266, 267, 268, 269, 270, 271, 272, 273, 274, 275, 276, 277, 278, 279, 280, 281, 282, 283, 284, 285, 286, 287, 288, 289, 290, 291, 292, 293, 294, 295, 296, 297, 298, 299, 300, 301, 302, 303, 304, 305, 306, 307, 308, 309, 310, 311, 312, 313, 314, 315, 316, 317, 318, 319, 320, 321, 322, 323, 324, 325, 326, 327, 328, 329, 330, 331, 332, 333, 334, 335, 336, 337, 338, 339, 340, 341, 342, 343, 344, 345, 346, 347, 348, 349, 350, 351, 352, 353, 354, 355, 356, 357, 358, 359, 360, 361, 362, 363, 364, 365, 366, 367, 368, 369, 370, 371, 372, 373, 374, 375, 376, 377, 378, 379, 380, 381, 382, 383, 384, 385, 386, 387, 388, 389, 390, 391, 392, 393, 394, 395, 396, 397, 398, 399, 400, 401, 402, 403, 404, 405, 406, 407, 408, 409, 410, 411, 412, 413, 414, 415, 416, 417, 418, 419, 420, 421, 422, 423, 424, 425, 426, 427, 428, 429, 430, 431, 432, 433, 434, 435, 436, 437, 438, 439, 440, 441, 442, 443, 444, 445, 446, 447, 448, 449, 450, 451, 452, 453, 454, 455, 456, 457, 458, 459, 460, 461, 462, 463, 464, 465, 466, 467, 468, 469, 470, 471, 472, 473, 474, 475, 476, 477, 478, 479, 480, 481, 482, 483, 484, 485, 486, 487, 488, 489, 490, 491, 492, 493, 494, 495, 496, 497, 498, 499, 500, 501, 502, 503, 504, 505, 506, 507, 508, 509, 510, 511, 512, 513, 514, 515, 516, 517, 518, 519, 520, 521, 522, 523, 524, 525, 526, 527, 528, 529, 530, 531, 532, 533, 534, 535, 536, 537, 538, 539, 540, 541, 542, 543, 544, 545, 546, 547, 548, 549, 550, 551, 552, 553, 554, 555, 556, 557, 558, 559, 560, 561, 562, 563, 564, 565, 566, 567, 568, 569, 570, 571, 572, 573, 574, 575, 576, 577, 578, 579, 580, 581, 582, 583, 584, 585, 586, 587, 588, 589, 590, 591, 592, 593, 594, 595, 596, 597, 598, 599, 600, 601, 602, 603, 604, 605, 606, 607, 608, 609, 610, 611, 612, 613, 614, 615, 616, 617, 618, 619, 620, 621, 622, 623, 624, 625, 626, 627, 628, 629, 630, 631, 632, 633, 634, 635, 636, 637, 638, 639, 640, 641, 642, 643, 644, 645, 646, 647, 648, 649, 650, 651, 652, 653, 654, 655, 656, 657, 658, 659, 660, 661, 662, 663, 664, 665, 666, 667, 668, 669, 670, 671, 672, 673, 674, 675, 676, 677, 678, 679, 680, 681, 682, 683, 684, 685, 686, 687, 688, 689, 690, 691, 692, 693, 694, 695, 696, 697, 698, 699, 700, 701, 702, 703, 704, 705, 706, 707, 708, 709, 710, 711, 712, 713, 714, 715, 716, 717, 718, 719, 720, 721, 722, 723, 724, 725, 726, 727, 728, 729, 730, 731, 732, 733, 734, 735, 736, 737, 738, 739, 740, 741, 742, 743, 744, 745, 746, 747, 748, 749, 750, 751, 752, 753, 754, 755, 756, 757, 758, 759, 760, 761, 762, 763, 764, 765, 766, 767, 768, 769, 770, 771, 772, 773, 774, 775, 776, 777, 778, 779, 780, 781, 782, 783, 784, 785, 786, 787, 788, 789, 790, 791, 792, 793, 794, 795, 796, 797, 798, 799, 800, 801, 802, 803, 804, 805, 806, 807, 808, 809, 810, 811, 812, 813, 814, 815, 816, 817, 818, 819, 820, 821, 822, 823, 824, 825, 826, 827, 828, 829, 830, 831, 832, 833, 834, 835, 836, 837, 838, 839, 840, 841, 842, 843, 844, 845, 846, 847, 848, 849, 850, 851, 852, 853, 854, 855, 856, 857, 858, 859, 860, 861, 862, 863, 864, 865, 866, 867, 868, 869, 870, 871, 872, 873, 874, 875, 876, 877, 878, 879, 880, 881, 882, 883, 884, 885, 886, 887, 888, 889, 890, 891, 892, 893, 894, 895, 896, 897, 898, 899, 900, 901, 902, 903, 904, 905, 906, 907, 908, 909, 910, 911, 912, 913, 914, 915, 916, 917, 918, 919, 920, 921, 922, 923, 924, 925, 926, 927, 928, 929, 930, 931, 932, 933, 934, 935, 936, 937, 938, 939, 940, 941, 942, 943, 944, 945, 946, 947, 948, 949, 950, 951, 952, 953, 954, 955, 956, 957, 958, 959, 960, 961, 962, 963, 964, 965, 966, 967, 968, 969, 970, 971, 972, 973, 974, 975, 976, 977, 978, 979, 980, 981, 982, 983, 984, 985, 986, 987, 988, 989, 990, 991, 992, 993, 994, 995, 996, 997, 998, 999, 1000.*

FIELD BOOK, N.E. 650

*Walter Murray
 South Canterbury
 20th Aug 1882*

CHECKED

*X. 10Z
 1/10/82
 26 Dec 82
 4/1/83*

3075

3652

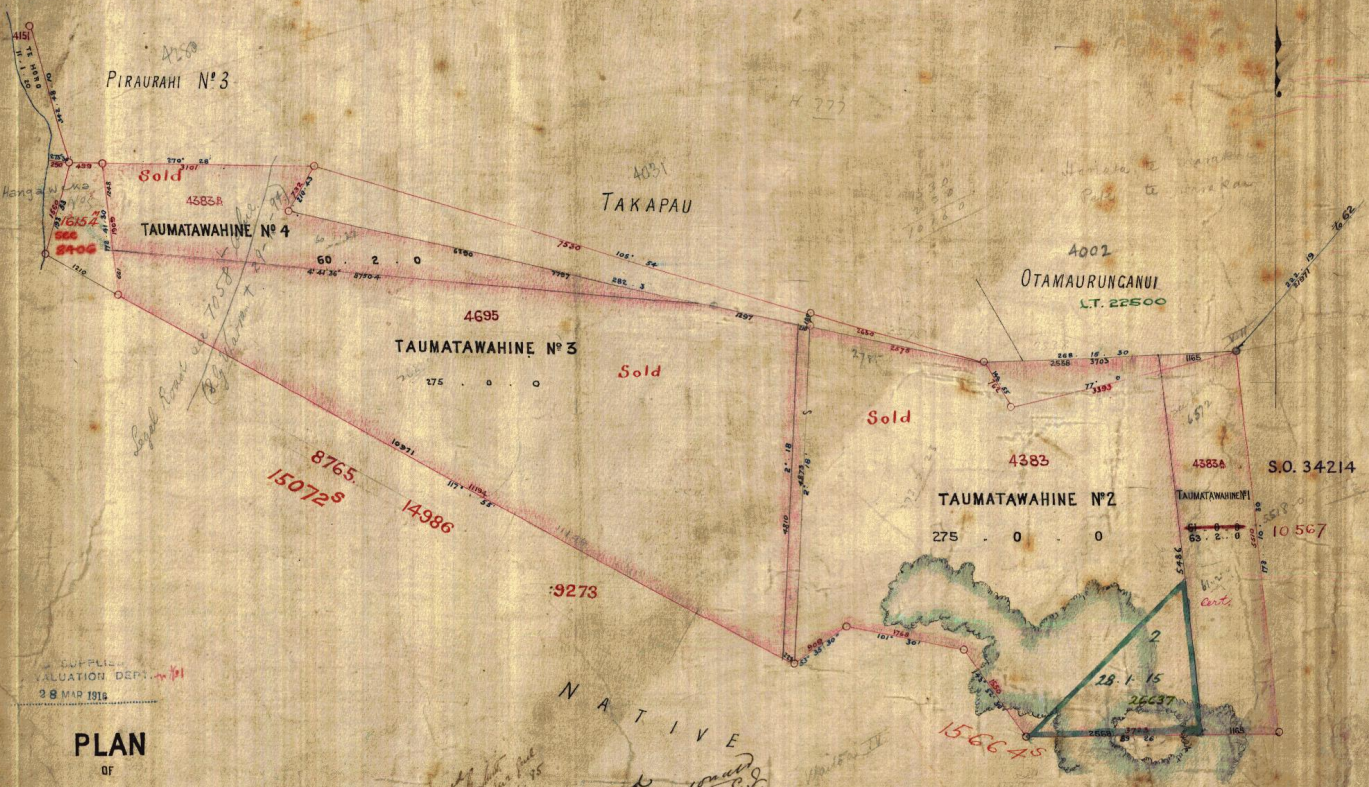

SUPPLIES
VALUATION DEPT.
28 MAR 1916

PLAN
OF

TAUMATAWAHINE
BLOCK IV WAITOA SURVEY DISTRICT

SURVEYED BY A. J. THORPE IN 1876
SCALE 10 CHAINS TO AN INCH

*Completed in Survey Office Auckland
16 when report made to Survey Block
Sheet & returned*

*Approved
10. 2. 86*

Ent on Block IV Waitoa
Record & Index Maps

Placed on Memorial Forms as for
Taumatawahine Nos 1, 2, 3, 4

*Walter G. Weston
Chief Clerk
27/5/86*

File under
4383, 4695